

CUBSTRUCTION

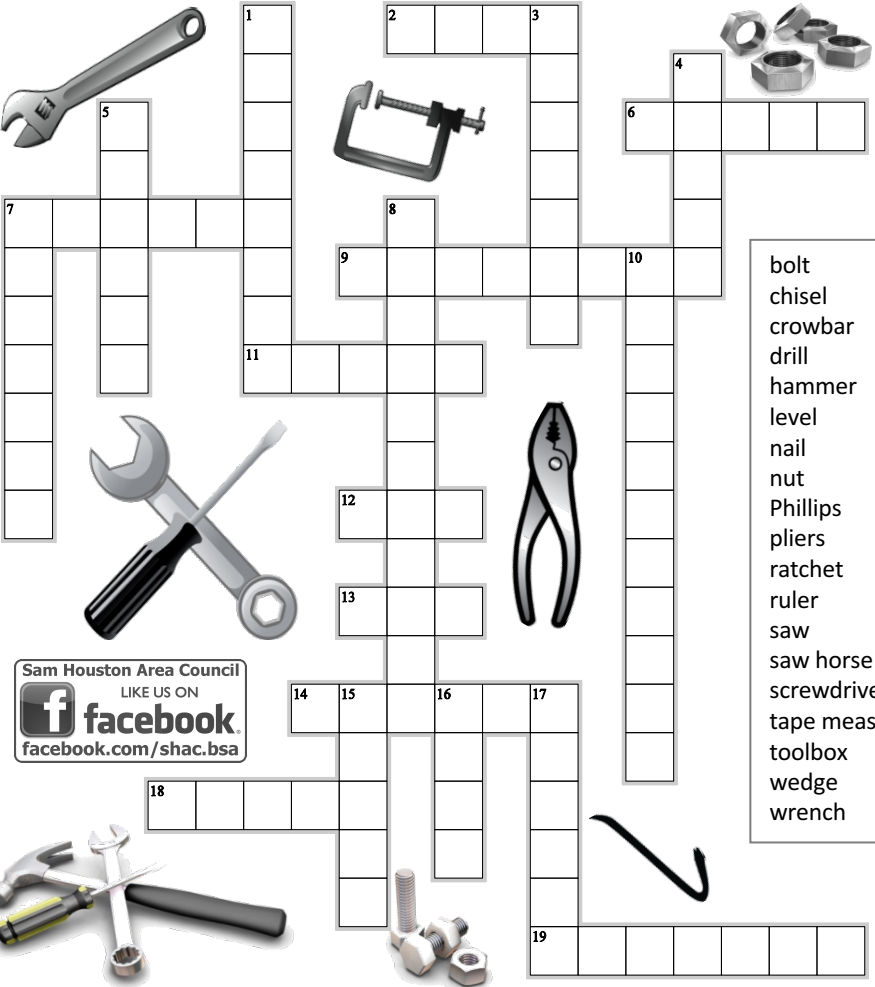

- bolt
- chisel
- crowbar
- drill
- hammer
- level
- nail
- nut
- Phillips pliers
- ratchet
- ruler
- saw
- saw horse
- screwdriver
- tape measure
- toolbox
- wedge
- wrench

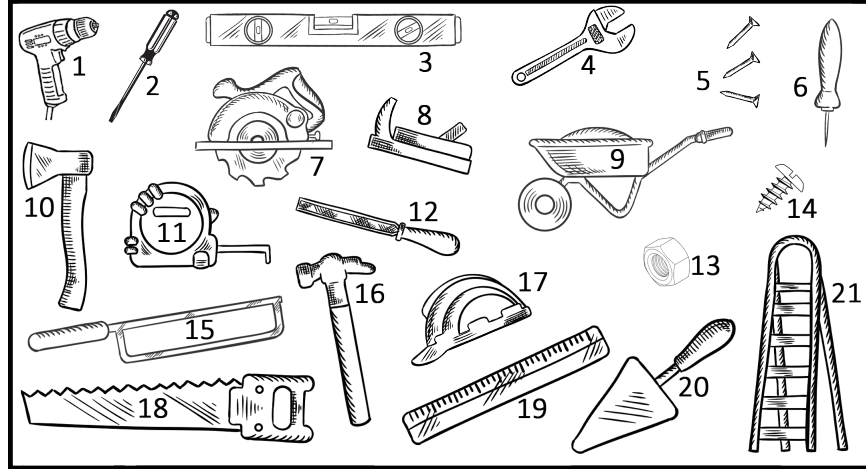

Place the appropriate number next to the named tool.

- | | | |
|------------------------|--------------|--------------------|
| _____ Awl | _____ File | _____ Saw |
| _____ Axe | _____ Hammer | _____ Screwdriver |
| _____ Bolt | _____ Ladder | _____ Tape measure |
| _____ Circular saw | _____ Level | _____ Trowel |
| _____ Construction hat | _____ Plane | _____ Wheelbarrow |
| _____ Coping saw | _____ Ruler | _____ Wrench |
| _____ Drill | _____ Nails | _____ Vice |

- Across**
2. a metal rod or pin that has a head at one end and a screw thread at the other to take a nut
 6. device for determining whether a surface is horizontal
 7. hand tool for working wood with a flat steel blade cutting edge attached to a handle
 9. frame on which wood is laid for sawing by hand
 11. a rod-shaped metal piece with a winding groove used for fastening solid pieces together
 12. tool used to cut hard material with a tooth-edged blade
 13. small square or hexagonal block with a threaded hole through the middle for screwing on the end of a bolt
 14. tool for holding, twisting, or turning nuts and bolts
 18. rotating tool for making circular holes
 19. device in which a toothed rack or wheel is engaged permitting motion in one direction only

- Down**
1. Phillips head noun special screwdriver with the head having two partial slots crossed at right angles
 3. chest to store tools
 4. piece shaped like a triangle used to split wood or rocks and to lift heavy weights
 5. small pincers with long jaws for bending wire or holding small objects
 7. heavy iron lever with one pointed end and one forged into a wedge shape
 8. tape marked off in units used for measuring
 10. tool for turning screws
 15. a straight strip marked off in units measuring
 16. a slender piece of metal having one end pointed and the other end flattened for hammering to hold separate pieces together
 17. tool used for driving in nails

TOOLS

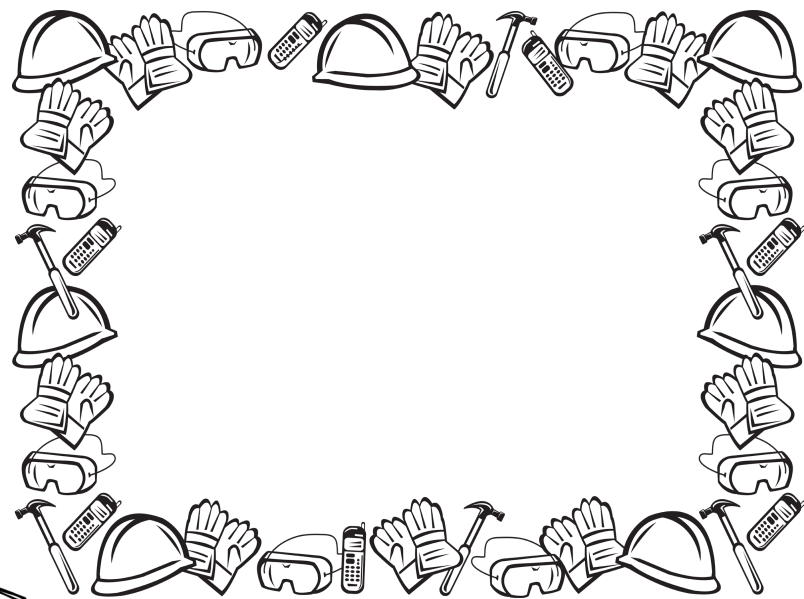

Sam Houston Area Council
 LIKE US ON
 **facebook**
facebook.com/shac.bsa

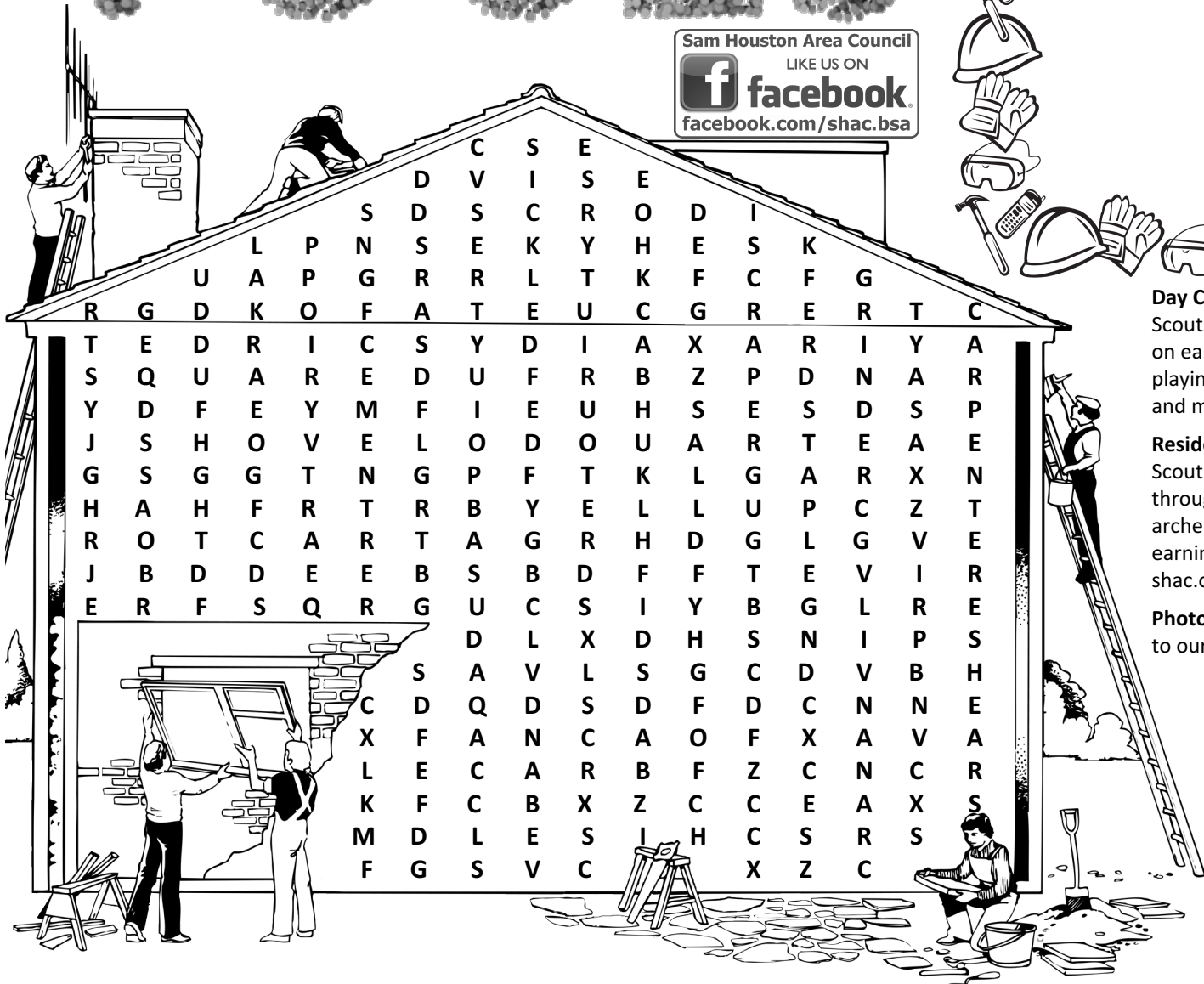

R	G	D	K	O	F	A	T	E	U	C	G	R	E	R	T	C
T	E	D	R	I	C	S	Y	D	I	A	X	A	R	I	Y	A
S	Q	U	A	R	E	D	U	F	R	B	Z	P	D	N	A	R
Y	D	F	E	Y	M	F	I	E	U	H	S	E	S	D	S	P
J	S	H	O	V	E	L	O	D	O	U	A	R	T	E	A	E
G	S	G	G	T	N	G	P	F	T	K	L	G	A	R	X	N
H	A	H	F	R	T	R	B	Y	E	L	L	U	P	C	Z	T
R	O	T	C	A	R	T	A	G	R	H	D	G	L	G	V	E
J	B	D	D	E	E	B	S	B	D	F	F	T	E	V	I	R
E	R	F	S	Q	R	G	U	C	S	I	Y	B	G	L	R	E
							D	L	X	D	H	S	N	I	P	S
							S	A	V	L	S	G	C	D	V	B
							C	D	Q	D	S	D	F	D	C	N
							X	F	A	N	C	A	O	F	X	A
							L	E	C	A	R	B	F	Z	C	N
							K	F	C	A	R	B	X	Z	C	A
							M	D	L	E	S	I	H	C	S	R
							F	G	S	V	C	X	Z	C		

Day Camp is a camp run by districts in June for Cub Scouts entering 1st through 5th grade and focuses on earning advancements, learning new skills, playing sports and games, crafts, BB guns, archery and making new friends. shac.org/day-camp

Resident Camp is a three-night campout at Bovay Scout Ranch during July for Scouts entering 1st through 5th grade. Activities include BB guns, archery, sports, nature, fishing, hiking, BMX bikes, earning rank advancements, campfire and more. shac.org/resident-camp

Photos: Send photos of your Scouting activities to our council Facebook page. fb.com/shac.bsa

ANVIL	SANDER
BACKHOE	SCRAPER
BRACE	SHEARS
BULLDOZER	SHOVEL
CARPENTER	SICKLE
CEMENT	SNIP
CHISEL	SPADE
GRINDER	SQUARE
PULLEY	STAPLE
RIVET	TRACTOR
ROUTER	WISE

CONSTRUCTION

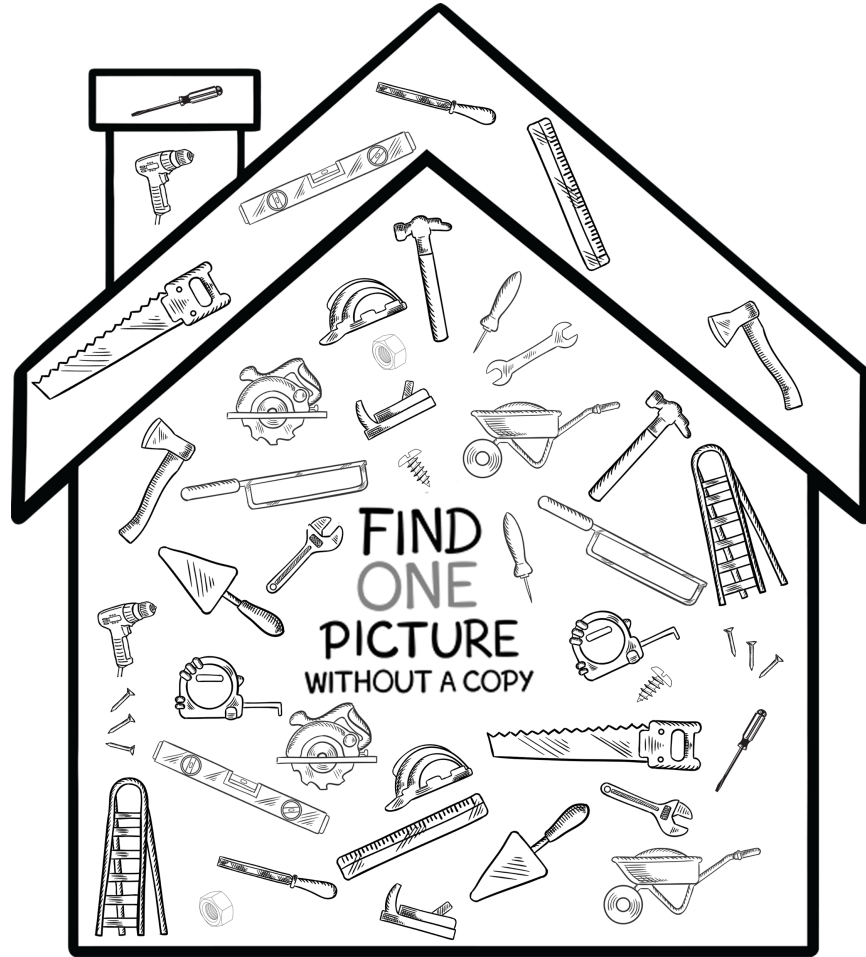
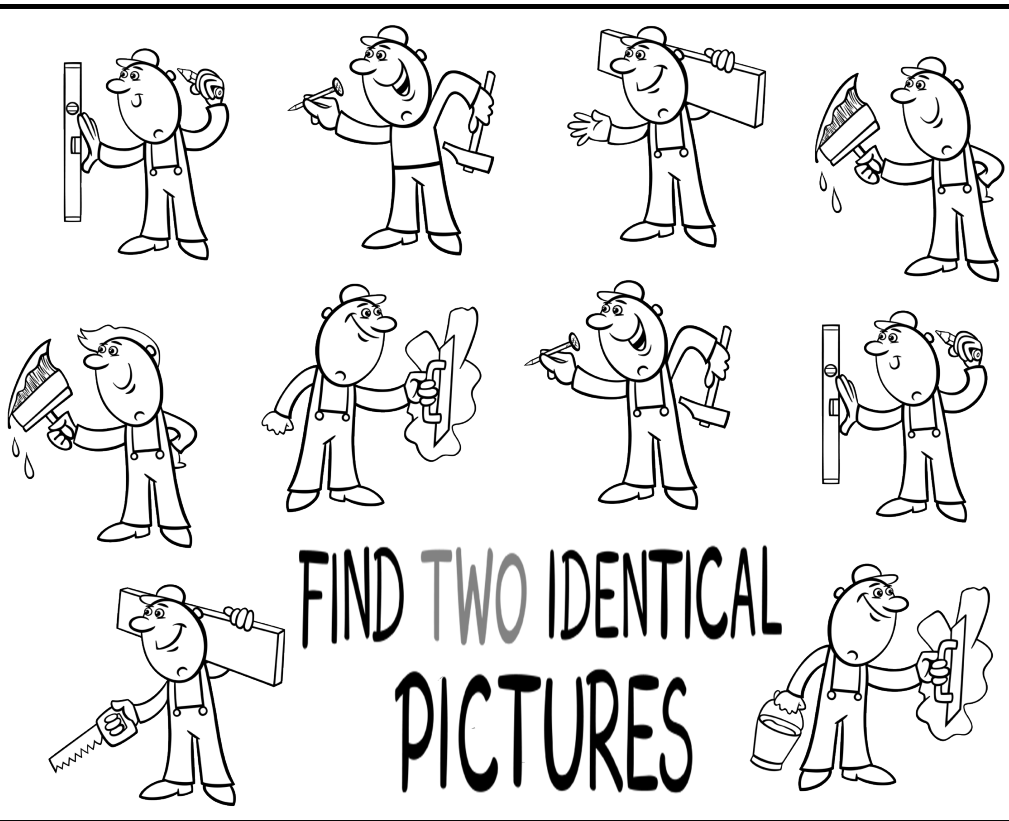

Day Camp is a camp run by districts in June for Cub Scouts entering 1st through 5th grade and focuses on earning advancements, learning new skills, playing sports and games, crafts, BB guns, archery and making new friends. shac.org/day-camp

Resident Camp is a three-night campout at Bovay Scout Ranch during July for Scouts entering 1st through 5th grade. Activities include BB guns, archery, sports, nature, fishing, hiking, BMX bikes, earning rank advancements, campfire and more. shac.org/resident-camp

Photos: Send us photos of your Scouting activities. fb.com/shac.bsa

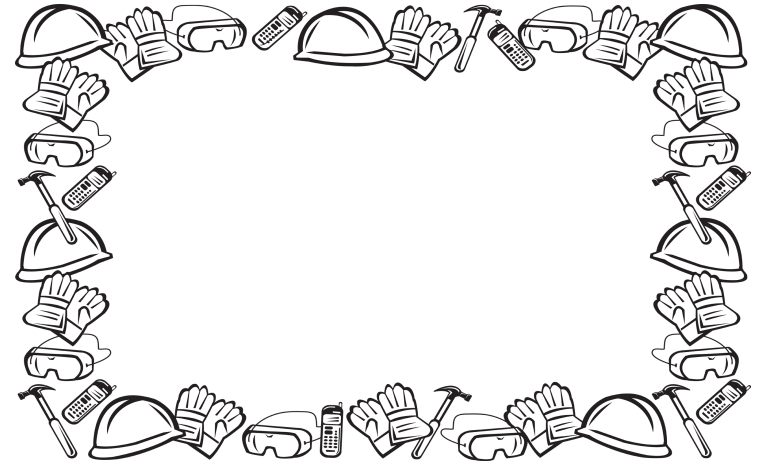

TOOLS

FIND 6 DIFFERENCES

